



City of
Lincoln

Bella Breeze Community Park

Community Workshop #2

12.11.2023



Welcome and Introductions

Araceli Cazarez, City of Lincoln Project Manager (araceli.cazarez@lincolnca.gov)

Dalton LaVoie, Landscape Architect, Stantec Project Manager



AGENDA ITEM

PRESENTER

Welcome and Introductions

Araceli Cazarez/City

Project Background and Schedule

Araceli Cazarez/City

Park Site Opportunities and Constraints

Dalton LaVoie/Stantec

Community Outreach Summary

Dalton LaVoie/Stantec

Preliminary Master Plan Concepts

Dalton LaVoie/Stantec

Summary & Next Steps

Araceli Cazarez/City



Project Background

- City of Lincoln has budgeted funds to master plan a new 18.5-acre park within the Twelve Bridges community.
- The master plan will provide recommendations for the park including appropriate uses, amenities, and an implementation strategy.
- City staff are working with design and engineering team at Stantec to master plan the site.
- Tonight we are presenting the concepts to the community and asking that you provide your feedback via the online survey.
 - Neighborhood of Residence
 - Pick your favorite
 - Rank the plans
 - Select Phase 1 Amenity Preferences
 - Comments, Questions, Suggestions and/or Ideas

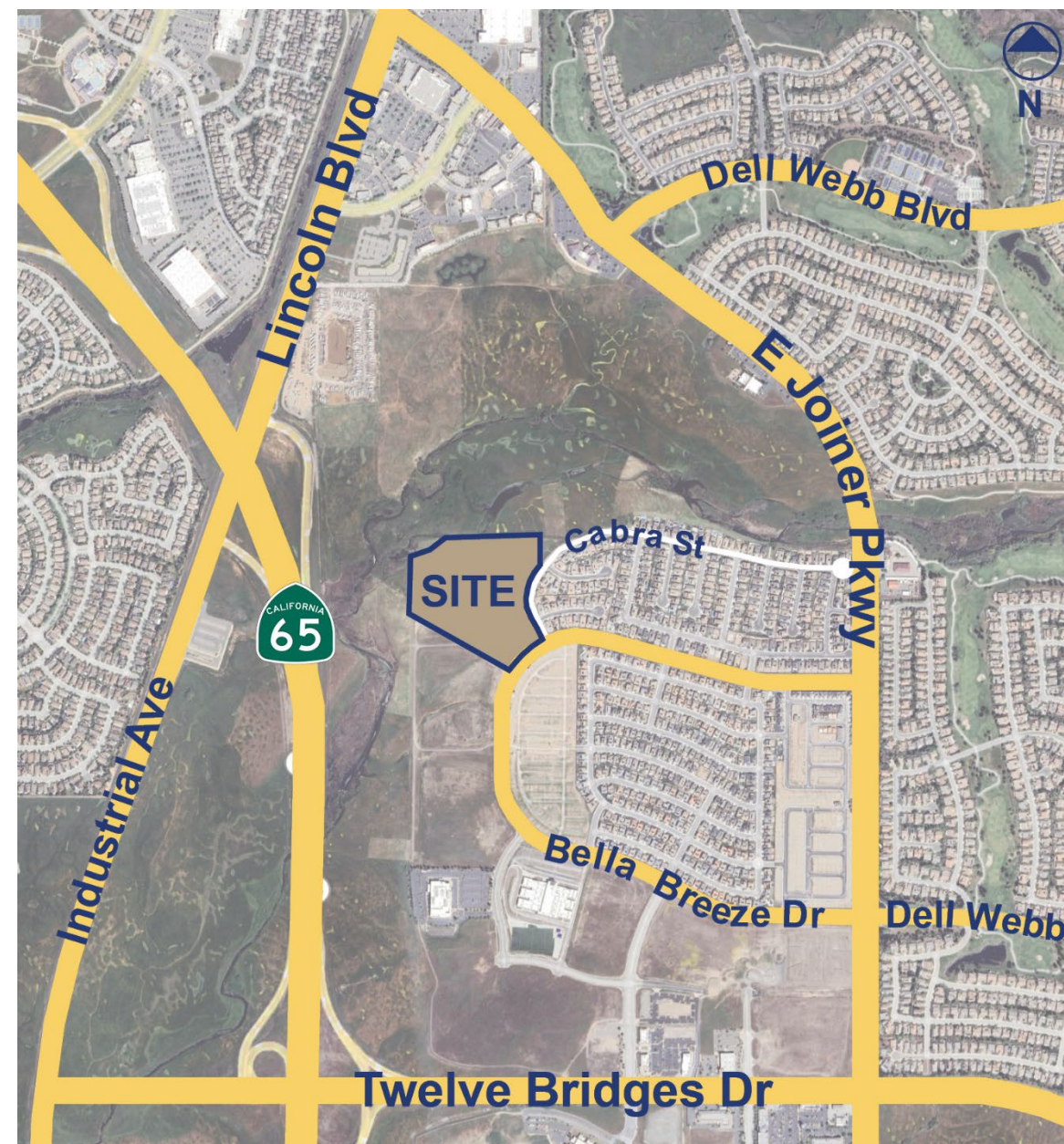

Project Schedule

- ✓ **October 9th – October 23rd, 2023**
 - Community Outreach Survey #1 – Amenity Preferences and Design Ideas. **COMPLETE**
- ✓ **October 17th, 2023**
 - Community Outreach Meeting #1 – Amenity Preferences and Design Ideas. Held virtually via ZOOM. **COMPLETE**
- ✓ **December 6th, 2023**
 - Parks and Recreation Committee Meeting #1 – Four Preliminary Design Concepts. **COMPLETE**
- **December 11th, 2023 WE ARE HERE**
 - Community Outreach Meeting #2 – Four Preliminary Design Concepts reviewed. In-person Twelve Bridges Library Willow Room.
- **December 11th – January 9th, 2023 WE ARE HERE**
 - Community Survey #2 - Four Preliminary Design Concepts and Phase 1 Construction Priorities.
- **March 2024**
 - Preferred Master Plan for approval at Park and Recreation Committee and City Council including Phase 1 boundary.
- **2025 Construction currently anticipated to begin**





Workshop Housekeeping

- **Overall Presentation**
 - Format
 - Questions
- **All questions/comments are recommended to be submitted to the online survey.**
- **Survey can be accessed by:**
 - Scanning the QR code
 - Visiting <https://tinyurl.com/bellabreeze>



  scan the QR code at left with your phone's camera to **PICK YOUR FAVORITE CONCEPT** or you can also visit: <https://tinyurl.com/bellabreeze>





Open Space Preserve

BELLA BREEZE COMMUNITY PARK SITE

E Joiner Parkway

Cabra St

Bella Breeze Drive

McCullough St (under construction)





Park Site Photos

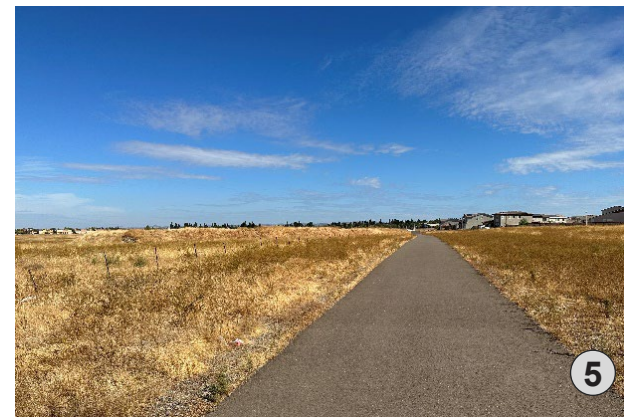
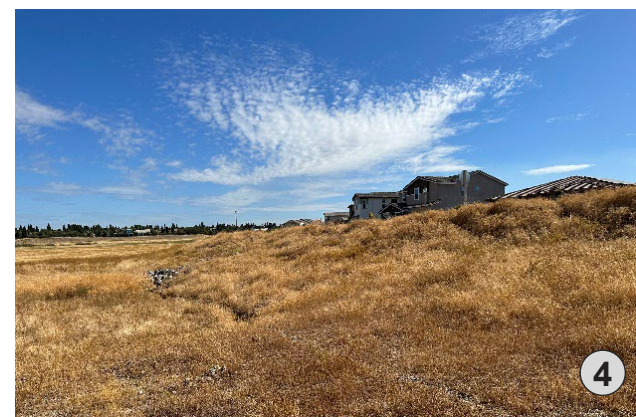
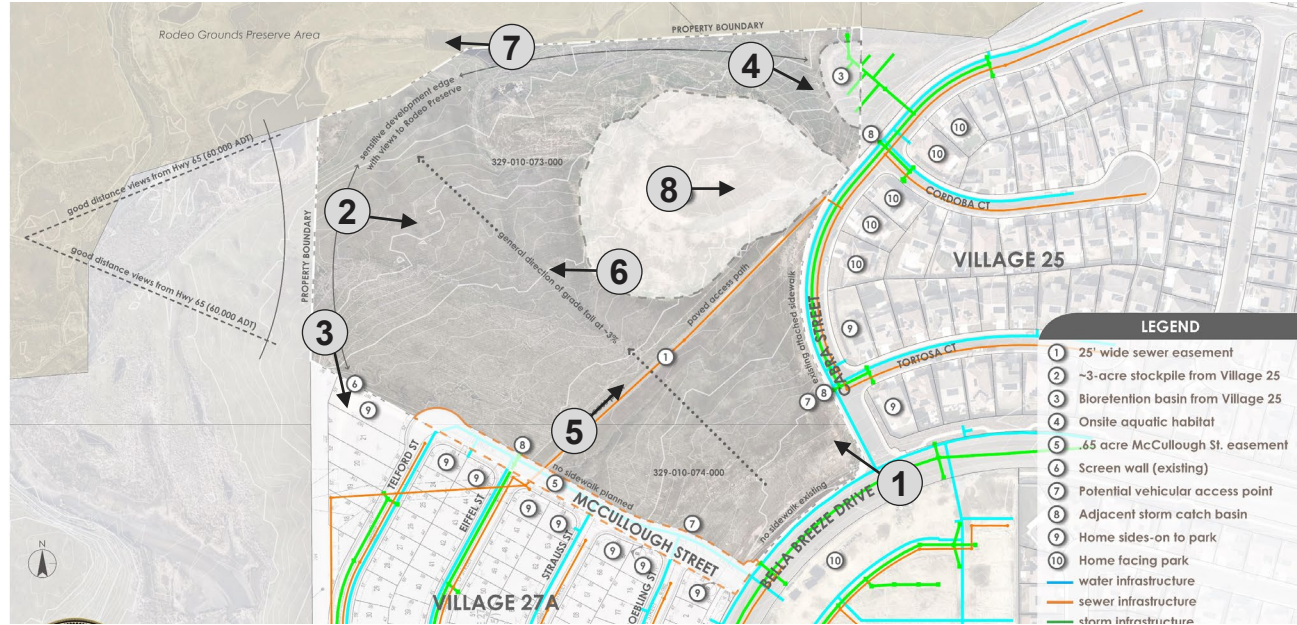



Preliminary Field Work

- **Site photography** for design layout and context.
- **Biological resources** on/adjacent the project site.
- **Cultural resources** on/adjacent the project site.
- **Base mapping:** topography, adjacent roadways/ramps, sidewalks, lighting, fences, existing utilities, stormwater features, and aerial imagery.
- **Subsurface conditions** to provide evaluation/recommendations for structure foundation design, pavement design, and soil fertility.





City of
Lincoln

Community Outreach Survey Summary



BELLA BREEZE COMMUNITY PARK

Results Summary

COMMUNITY OUTREACH SURVEY #1

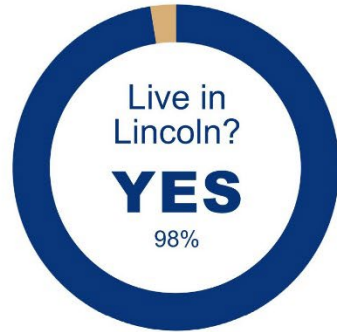
Number of responses
1,066



How did you hear about the survey?



What area of Lincoln is your residence?





What age ranges use City Parks with you?

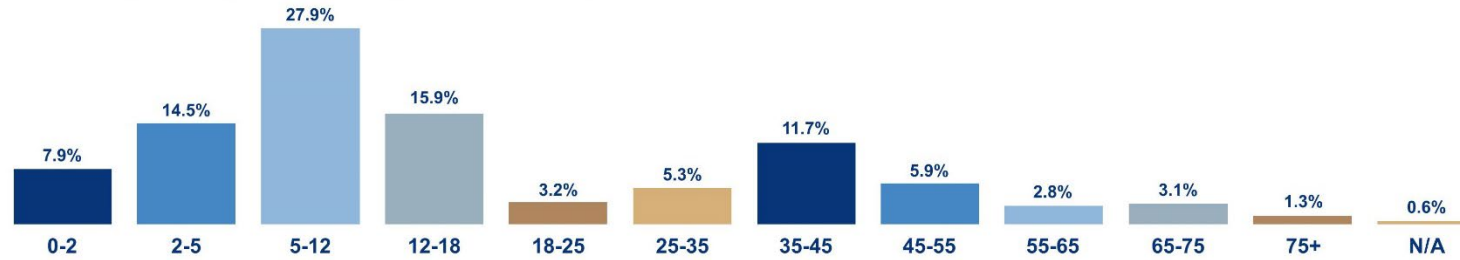

Which organized City sports leagues do you volunteer, participate, or serve in?



DESIGN Ideas

TOP 5 MOST COMMON:

- SPORTS FIELDS (#1 OVERALL NEED)
- PLAYGROUND (#1 SHADED PLAY)
- EXAMPLE PARKS (#1 WHITNEY RANCH)
- THEME (#1 NATURE/NATURAL)
- SHADE (#1 OVERALL NEED)

SAFETY Ideas

TOP 5 MOST COMMON:

- LIGHTING (#1 SITE WIDE + FIELDS)
- PLAYGROUND (#1 FENCED TODDLERS)
- CAMERAS (#1 INCLUDE IN PROJECT)
- BATHROOMS (#1 INCLUDE IN PROJECT)
- SHADE (#1 OVERALL + OVER PLAY)

BEAUTIFICATION Ideas

TOP 5 MOST COMMON:

- TREES (LOTS OF SHADE TREES)
- AMENITIES (PROVIDE SHADE)
- ART (LOCAL/COMMUNITY ART)
- OVERALL DESIGN (PATHS W PLANTS)
- SHRUBS (FLOWERING)





What are your **TOP 10** amenities for the park?

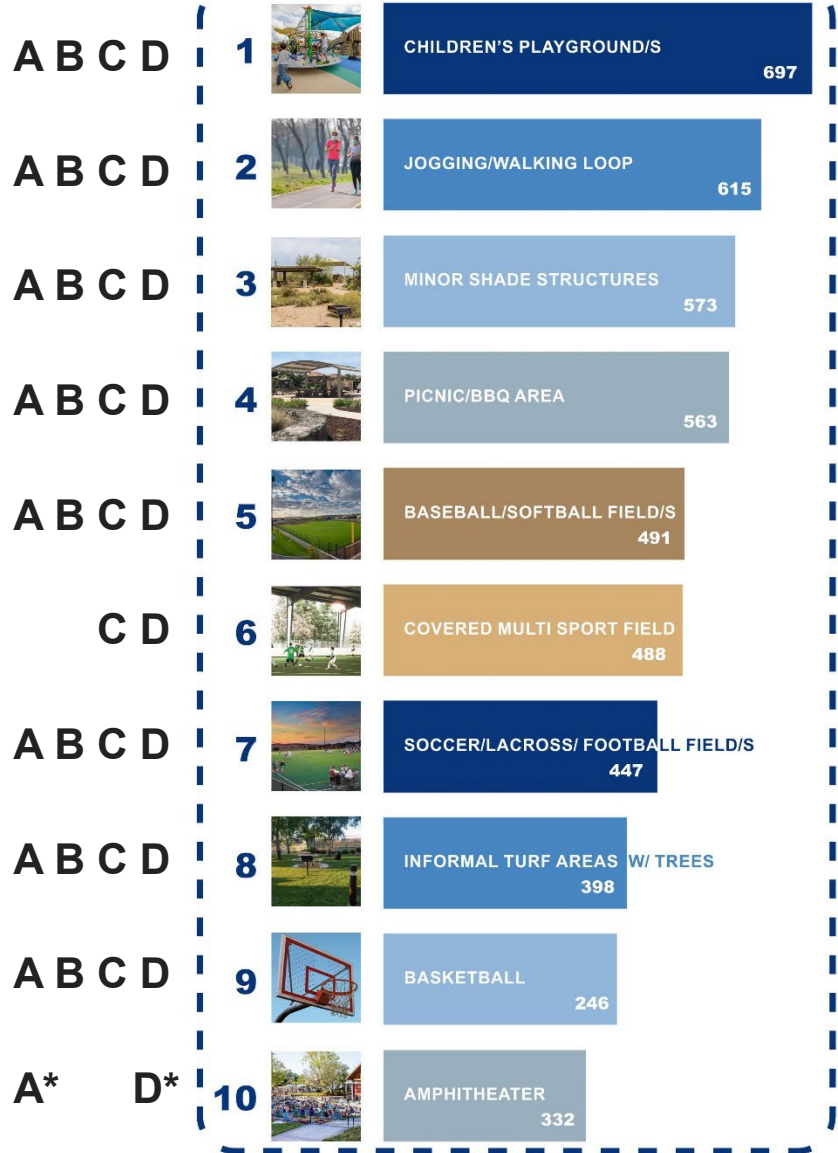

A B C D

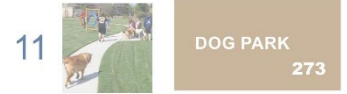

A B D



D



A*B*C*D*

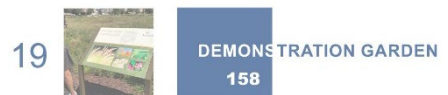
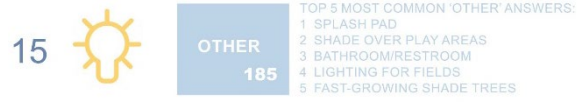

Note: where major elements are included and labeled on the following preliminary master plan concepts, they have a corresponding 'A', 'B', 'C', and/or 'D' next to them. Minor elements may still be included in the master plan, pending additional feedback.



Children's Playground 2-5 year old (shaded, fenced)



Large Shade Structure/Picnic Area

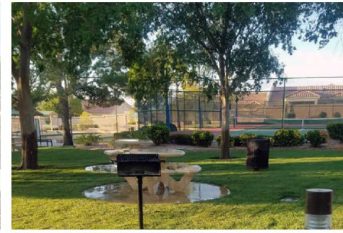

Informal Turf Area with Shade Trees



Bike Park/Pump Track



Stormwater Basin



Children's Playground 5-12 year old (shaded)



Baseball Field (300' depth, 90' bases)



Basketball Court



Concession Stand with Restroom



Pickleball Courts (4)

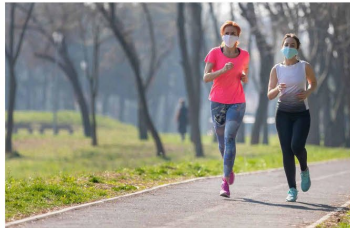

Jogging Walking Perimeter Loop Trail



Baseball/Softball Field (200' depth, 60' bases)



Covered Multi-Sport Field



Restroom at/near Play Area



Nature Preserve Edge Fencing (Post and Cable)



Minor Shade Structure/Picnic Area



Football/Soccer/Lacrosse/etc. Field (natural turf)



Dog Park (Separate Small and Large Dog Areas)



On-Site Parking Lot



Shrub Planter Area



scan the QR code at left with your phone's camera to
PICK YOUR FAVORITE CONCEPT
or you can also visit: <https://tinyurl.com/bellabreeze>

BELLA BREEZE COMMUNITY PARK
Preliminary Master Plan Concepts | Reference Images

12.08.2023



CONCEPT A

\$19.21M

| | | | |
|----|--|----------------------------------|-----|
| A | | CHILDREN'S PLAYGROUND/S | 697 |
| A | | JOGGING/WALKING LOOP | 615 |
| A | | MINOR SHADE STRUCTURES | 573 |
| A | | PICNIC/BBQ AREA | 563 |
| A | | BASEBALL/SOFTBALL FIELD/S | 491 |
| A | | COVERED MULTI SPORT FIELD | 488 |
| A | | SOCCER/LACROSS/ FOOTBALL FIELD/S | 447 |
| A | | INFORMAL TURF AREAS W/ TREES | 398 |
| A | | BASKETBALL | 246 |
| A* | | AMPHITHEATER | 332 |

| | | | |
|----|--|------------------------------------|-----|
| A | | DOG PARK | 273 |
| A | | WILDLIFE FEATURES | 259 |
| A | | PICKLEBALL | 246 |
| A | | BIKE PARK/PUMP TRACK | 242 |
| A* | | OTHER | 185 |
| | | TOP 5 MOST COMMON 'OTHER' ANSWERS: | |
| | | 1. SPLASH PAD | |
| | | 2. SHADE OVER PLAY AREAS | |
| | | 3. BATHROOM/RESTROOM | |
| | | 4. LIGHTING FOR FIELDS | |
| | | 5. FAST-GROWING SHADE TREES | |
| | | SAND VOLLEYBALL | 178 |
| | | PUBLIC ART | 168 |
| | | OUTDOOR EXERCISE EQUIPMENT | 159 |
| | | DEMONSTRATION GARDEN | 158 |
| | | TENNIS COURTS | 148 |



KEY NOTE LEGEND

- 1 Children's Playground 2-5 year old (shaded, fenced)
- 2 Children's Playground 5-12 year old (shaded)
- 3 Jogging Walking Perimeter Loop Trail
- 4 Minor Shade Structure/Picnic Area
- 5 Large Shade Structure/Picnic Area
- 6 Baseball Field (300' depth, 90' bases, natural turf)
- 7 Baseball/Softball Field (200' depth, 60' bases, natural turf)
- 8 Football/Soccer/Lacrosse/etc. Field (natural turf)
- 9 Informal Turf Area with Shade Trees
- 10 Basketball Court
- 11 Temporary Stage Location for Field Amphitheater Use
- 12 Dog Park (Small Dogs)
- 13 Dog Park (Large Dogs)
- 14 Concession Stand with Restroom
- 15 Restroom at/near Play Area
- 16 On-Site Parking Lot (~150 stalls)
- 17 Stormwater Basin
- 18 Pickleball Courts (4)

GRAPHICAL LEGEND

- Structure (Metal Roof)
- Structure (Fabric Roof)
- Shade Tree
- Grass (Natural)
- Asphalt
- Concrete
- Shrub Planter Area
- Infield Fines (at Ballfields)
- Wood Fiber Surfacing (at Playgrounds)
- Decomposed Granite
- Stormwater Basin
- Fence | Tube Steel (at 2-5 year old Playground)
- Fence | Post and Cable (at Open Space Edge)
- Fence | Chain Link (at Dog Park and Ball Fields)
- Retaining Wall (9' height or less)

NOTE 1: Lighting is planned for the fields, walkways, and parking lot's.

Note: where major elements are included and labeled, they have a corresponding 'A' next to them. Minor elements may still be included in the master plan, pending additional feedback.

scan the QR code at left with your phone's camera to
PICK YOUR FAVORITE CONCEPT
 or you can also visit: <https://tinyurl.com/bellabreeze>

BELLA BREEZE COMMUNITY PARK
 Preliminary Master Plan Concept | **Alternative A**

12.07.2023



CONCEPT B

\$19.06M

| | | | |
|---|--|----------------------------------|-----|
| B | | CHILDREN'S PLAYGROUND/S | 697 |
| B | | JOGGING/WALKING LOOP | 615 |
| B | | MINOR SHADE STRUCTURES | 573 |
| B | | PICNIC/BBQ AREA | 563 |
| B | | BASEBALL/SOFTBALL FIELD/S | 491 |
| B | | COVERED MULTI SPORT FIELD | 488 |
| B | | SOCCER/LACROSS/ FOOTBALL FIELD/S | 447 |
| B | | INFORMAL TURF AREAS W/ TREES | 398 |
| B | | BASKETBALL | 246 |
| B | | AMPHITHEATER | 332 |

| | | | |
|----|--|------------------------------------|-----|
| B | | DOG PARK | 273 |
| B | | WILDLIFE FEATURES | 259 |
| B | | PICKLEBALL | 246 |
| B | | BIKE PARK/PUMP TRACK | 242 |
| B* | | OTHER | 185 |
| | | TOP 5 MOST COMMON 'OTHER' ANSWERS: | |
| | | 1. SPLASH PAD | |
| | | 2. SHADE OVER PLAY AREAS | |
| | | 3. BATHROOM/RESTROOM | |
| | | 4. LIGHTING FOR FIELDS | |
| | | 5. FAST-GROWING SHADE TREES | |
| | | SAND VOLLEYBALL | 178 |
| | | PUBLIC ART | 168 |
| | | OUTDOOR EXERCISE EQUIPMENT | 159 |
| | | DEMONSTRATION GARDEN | 158 |
| | | TENNIS COURTS | 148 |



KEY NOTE LEGEND

- Children's Playground 2-5 year old (shaded, fenced)
- Children's Playground 5-12 year old (shaded)
- Jogging Walking Perimeter Loop Trail
- Minor Shade Structure/Picnic Area
- Large Shade Structure/Picnic Area
- Baseball Field (300' depth, 90' bases, natural turf)
- Baseball/Softball Field (200' depth, 60' bases, natural turf)
- Football/Soccer/Lacrosse/etc. Field (natural turf)
- Informal Turf Area with Shade Trees
- Basketball Court
- Nature Preserve Edge Fencing (Post and Cable)
- Dog Park (Small Dogs)
- Dog Park (Large Dogs)
- Concession Stand with Restroom
- Native Garden Area
- On-Site Parking Lot (~110 stalls)
- Stormwater Basin
- Pickleball Courts (4)

GRAPHICAL LEGEND

- Structure (Metal Roof)
- Structure (Fabric Roof)
- Shade Tree
- Grass (Natural)
- Asphalt
- Concrete
- Shrub Planter Area
- Infield Fines (at Ballfields)
- Wood Fiber Surfacing (at Playgrounds)
- Decomposed Granite
- Stormwater Basin
- Fence | Tube Steel (at 2-5 year old Playground)
- Fence | Post and Cable (at Open Space Edge)
- Fence | Chain Link (at Dog Park and Ball Fields)
- Retaining Wall (9' height or less)

Note: where major elements are included and labeled, they have a corresponding 'B' next to them. Minor elements may still be included in the master plan, pending additional feedback.

scan the QR code at left with your phone's camera to
PICK YOUR FAVORITE CONCEPT
 or you can also visit: <https://tinyurl.com/bellabreeze>

BELLA BREEZE COMMUNITY PARK
 Preliminary Master Plan Concept | **Alternative B**
 12.07.2023



CONCEPT C

\$20.98M

| | | | |
|---|--|----------------------------------|-----|
| C | | CHILDREN'S PLAYGROUND/S | 697 |
| C | | JOGGING/WALKING LOOP | 615 |
| C | | MINOR SHADE STRUCTURES | 573 |
| C | | PICNIC/BBQ AREA | 563 |
| C | | BASEBALL/SOFTBALL FIELD/S | 491 |
| C | | COVERED MULTI SPORT FIELD | 488 |
| C | | SOCCER/LACROSS/ FOOTBALL FIELD/S | 447 |
| C | | INFORMAL TURF AREAS W/ TREES | 398 |
| C | | BASKETBALL | 246 |
| C | | AMPHITHEATER | 332 |

| | | | |
|----|--|----------------------------|-----|
| C | | DOG PARK | 273 |
| C | | WILDLIFE FEATURES | 259 |
| C | | PICKLEBALL | 246 |
| C | | BIKE PARK/PUMP TRACK | 242 |
| C* | | OTHER | 185 |
| C | | SAND VOLLEYBALL | 178 |
| C | | PUBLIC ART | 168 |
| C | | OUTDOOR EXERCISE EQUIPMENT | 159 |
| C | | DEMONSTRATION GARDEN | 158 |
| C | | TENNIS COURTS | 148 |

TOP 5 MOST COMMON 'OTHER' ANSWERS:
 1. SPLASH PAD
 2. SHADE OVER PLAY AREAS
 3. BATHROOM/RESTROOM
 4. LIGHTING FOR FIELDS
 5. FAST-GROWING SHADE TREES



\$20.98M

KEY NOTE LEGEND

- 1 Children's Playground 2-5 year old (shaded, fenced)
- 2 Children's Playground 5-12 year old (shaded)
- 3 Jogging Walking Perimeter Loop Trail
- 4 Minor Shade Structure/Picnic Area
- 5 Large Shade Structure/Picnic Area
- 6 Baseball Field (300' depth, 90' bases, natural turf)
- 7 Baseball/Softball Field (200' depth, 60' bases, natural turf)
- 8 Football/Soccer/Lacrosse/etc. Field (natural turf)
- 9 Informal Turf Area with Shade Trees
- 10 Basketball Court
- 11 Covered Multi-Sport Field
- 12 Dog Park (Small Dogs)
- 13 Dog Park (Large Dogs)
- 14 Concession Stand with Restroom
- 15 Restroom at/near Play Area
- 16 On-Site Parking Lot (~110 stalls)
- 17 Stormwater Basin
- 18 Nature Preserve Edge Fencing (Post and Cable)

GRAPHICAL LEGEND

- Structure (Metal Roof)
- Structure (Fabric Roof)
- Shade Tree
- Grass (Natural)
- Asphalt
- Concrete
- Shrub Planter Area
- Infield Fines (at Ballfields)
- Wood Fiber Surfacing (at Playgrounds)
- Decomposed Granite
- Stormwater Basin
- Fence | Tube Steel (at 2-5 year old Playground)
- Fence | Post and Cable (at Open Space Edge)
- Fence | Chain Link (at Dog Park and Ball Fields)
- Retaining Wall (9' height or less)

NOTE 1: Lighting is planned for the fields, walkways, and parking lot's.

Note: where major elements are included and labeled, they have a corresponding 'C' next to them. Minor elements may still be included in the master plan, pending additional feedback.

scan the QR code at left with your phone's camera to
PICK YOUR FAVORITE CONCEPT
 or you can also visit: <https://tinyurl.com/bellabreeze>

BELLA BREEZE COMMUNITY PARK
 Preliminary Master Plan Concept | **Alternative C**
 12.07.2023



CONCEPT D

\$20.72M

| | | | |
|----|--|----------------------------------|-----|
| D | | CHILDREN'S PLAYGROUND/S | 697 |
| D | | JOGGING/WALKING LOOP | 615 |
| D | | MINOR SHADE STRUCTURES | 573 |
| D | | PICNIC/BBQ AREA | 563 |
| D | | BASEBALL/SOFTBALL FIELD/S | 491 |
| D | | COVERED MULTI SPORT FIELD | 488 |
| D | | SOCCER/LACROSS/ FOOTBALL FIELD/S | 447 |
| D | | INFORMAL TURF AREAS W/ TREES | 398 |
| D | | BASKETBALL | 246 |
| D* | | AMPHITHEATER | 332 |

| | | | |
|----|--|----------------------------|-----|
| D | | DOG PARK | 273 |
| | | WILDLIFE FEATURES | 259 |
| D | | PICKLEBALL | 246 |
| D | | BIKE PARK/PUMP TRACK | 242 |
| D* | | OTHER | 185 |
| | | SAND VOLLEYBALL | 178 |
| | | PUBLIC ART | 168 |
| | | OUTDOOR EXERCISE EQUIPMENT | 159 |
| | | DEMONSTRATION GARDEN | 158 |
| | | TENNIS COURTS | 148 |

TOP 5 MOST COMMON 'OTHER' ANSWERS:
 1. SPLASH PAD
 2. SHADE OVER PLAY AREAS
 3. BATHROOM/RESTROOM
 4. LIGHTING FOR FIELDS
 5. FAST-GROWING SHADE TREES



KEY NOTE LEGEND

- 1 Children's Playground 2-5 year old (shaded, fenced)
- 2 Children's Playground 5-12 year old (shaded)
- 3 Jogging Walking Perimeter Loop Trail
- 4 Minor Shade Structure/Picnic Area
- 5 Large Shade Structure/Picnic Area
- 6 Baseball Field (300' depth, 90' bases, natural turf)
- 7 Baseball/Softball Field (200' depth, 60' bases, natural turf)
- 8 Football/Soccer/Lacrosse/etc. Field (natural turf)
- 9 Informal Turf Area with Shade Trees
- 10 Basketball Court
- 11 Covered Multi-Sport Field
- 12 Dog Park (Separate Small and Large Dog Areas)
- 13 Bike Park/Pump Track
- 14 Concession Stand with Restroom
- 15 Restroom at/near Play Area
- 16 On-Site Parking Lot (~180 stalls)
- 17 Stormwater Basin
- 18 Pickleball Courts (4)

GRAPHICAL LEGEND

- Structure (Metal Roof)
- Structure (Fabric Roof)
- Shade Tree
- Grass (Natural)
- Asphalt
- Concrete
- Shrub Planter Area
- Infield Fines (at Ballfields)
- Wood Fiber Surfacing (at Playgrounds)
- Decomposed Granite
- Stormwater Basin
- Fence | Tube Steel (at 2-5 year old Playground)
- Fence | Post and Cable (at Open Space Edge)
- Fence | Chain Link (at Dog Park and Ball Fields)
- Retaining Wall (9' height or less)

Note: where major elements are included and labeled, they have a corresponding 'D' next to them. Minor elements may still be included in the master plan, pending additional feedback.



scan the QR code at left with your phone's camera to
PICK YOUR FAVORITE CONCEPT
 or you can also visit: <https://tinyurl.com/bellabreeze>

BELLA BREEZE COMMUNITY PARK
 Preliminary Master Plan Concept | **Alternative D**

Summary & Next Steps

- ✓ **October 9th – October 23rd, 2023**
 - Community Outreach Survey #1 – Amenity Preferences and Design Ideas.
- ✓ **October 17th, 2023**
 - Community Outreach Meeting #1 – Amenity Preferences and Design Ideas. Held virtually via ZOOM.
- ✓ **December 6th, 2023**
 - Parks and Recreation Committee Meeting #1 – Four Preliminary Design Concepts.
- ✓ **December 11th, 2023**
 - Community Outreach Meeting #2 – Four Preliminary Design Concepts reviewed. In-person Twelve Bridges Library Willow Room.
- **December 11th – January 9th, 2023 OPEN NOW!**
 - Community Survey #2 – Four Preliminary Design Concepts and Phase 1 Construction Priorities.
- **March, 2024 NEXT UP**
 - Preferred Master Plan for approval at Park and Recreation Committee and City Council including Phase 1 boundary.
- **2025 Construction currently anticipated to begin**



Bella Breeze Master Plan Website



\$19.21M

| KEY NOTE LEGEND | |
|-----------------|---|
| 1 | Children's Playground 2-5 year old (shaded, fenced) |
| 2 | Children's Playground 5-12 year old (shaded) |
| 3 | Jogging Walking Perimeter Loop Trail |
| 4 | Minor Shade Structure/Picnic Area |
| 5 | Large Shade Structure/Picnic Area |
| 6 | Baseball Field (300' depth, 90' bases, natural turf) |
| 7 | Baseball/Softball Field (200' depth, 60' bases, natural turf) |
| 8 | Football/Soccer/Lacrosse/etc. Field (natural turf) |
| 9 | Informal Turf Area with Shade Trees |
| 10 | Basketball Court |
| 11 | Temporary Stage Location for Field Amphitheater Use |
| 12 | Dog Park (Small Dogs) |
| 13 | Dog Park (Large Dogs) |
| 14 | Concession Stand with Restroom |
| 15 | Restroom at/near Play Area |
| 16 | On-Site Parking Lot (~150 stalls) |
| 17 | Stormwater Basin |
| 18 | Pickleball Courts (4) |

| GRAPHICAL LEGEND | |
|--------------------|--|
| [Red Box] | Structure (Metal Roof) |
| [Blue Box] | Structure (Fabric Roof) |
| [Green Circle] | Shade Tree |
| [Dark Green Box] | Grass (Natural) |
| [Dark Grey Box] | Asphalt |
| [Light Grey Box] | Concrete |
| [Brown Box] | Shrub Planter Area |
| [Orange Box] | Infield Fines (at Ballfields) |
| [Light Orange Box] | Wood Fiber Surfacing (at Playgrounds) |
| [Light Brown Box] | Decomposed Granite |
| [Dark Green Box] | Stormwater Basin |
| [Dashed Line] | Fence Tube Steel (at 2-5 year old Playground) |
| [Dashed Line] | Fence Post and Cable (at Open Space Edge) |
| [Dashed Line] | Fence Chain Link (at Dog Park and Ball Fields) |
| [Dashed Line] | Retaining Wall (9' height or less) |



\$19.06M

| KEY NOTE LEGEND | |
|-----------------|---|
| 1 | Children's Playground 2-5 year old (shaded, fenced) |
| 2 | Children's Playground 5-12 year old (shaded) |
| 3 | Jogging Walking Perimeter Loop Trail |
| 4 | Minor Shade Structure/Picnic Area |
| 5 | Large Shade Structure/Picnic Area |
| 6 | Baseball Field (300' depth, 90' bases, natural turf) |
| 7 | Baseball/Softball Field (200' depth, 60' bases, natural turf) |
| 8 | Football/Soccer/Lacrosse/etc. Field (natural turf) |
| 9 | Informal Turf Area with Shade Trees |
| 10 | Basketball Court |
| 11 | Nature Preserve Edge Fencing (Post and Cable) |
| 12 | Dog Park (Small Dogs) |
| 13 | Dog Park (Large Dogs) |
| 14 | Concession Stand with Restroom |
| 15 | Native Garden Area |
| 16 | On-Site Parking Lot (~110 stalls) |
| 17 | Stormwater Basin |
| 18 | Pickleball Courts (4) |

| GRAPHICAL LEGEND | |
|--------------------|--|
| [Red Box] | Structure (Metal Roof) |
| [Blue Box] | Structure (Fabric Roof) |
| [Green Circle] | Shade Tree |
| [Dark Green Box] | Grass (Natural) |
| [Dark Grey Box] | Asphalt |
| [Light Grey Box] | Concrete |
| [Brown Box] | Shrub Planter Area |
| [Orange Box] | Infield Fines (at Ballfields) |
| [Light Orange Box] | Wood Fiber Surfacing (at Playgrounds) |
| [Light Brown Box] | Decomposed Granite |
| [Dark Green Box] | Stormwater Basin |
| [Dashed Line] | Fence Tube Steel (at 2-5 year old Playground) |
| [Dashed Line] | Fence Post and Cable (at Open Space Edge) |
| [Dashed Line] | Fence Chain Link (at Dog Park and Ball Fields) |
| [Dashed Line] | Retaining Wall (9' height or less) |



\$20.98M

| KEY NOTE LEGEND | |
|-----------------|---|
| 1 | Children's Playground 2-5 year old (shaded, fenced) |
| 2 | Children's Playground 5-12 year old (shaded) |
| 3 | Jogging Walking Perimeter Loop Trail |
| 4 | Minor Shade Structure/Picnic Area |
| 5 | Large Shade Structure/Picnic Area |
| 6 | Baseball Field (300' depth, 90' bases, natural turf) |
| 7 | Baseball/Softball Field (200' depth, 60' bases, natural turf) |
| 8 | Football/Soccer/Lacrosse/etc. Field (natural turf) |
| 9 | Informal Turf Area with Shade Trees |
| 10 | Basketball Court |
| 11 | Covered Multi-Sport Field |
| 12 | Dog Park (Small Dogs) |
| 13 | Dog Park (Large Dogs) |
| 14 | Concession Stand with Restroom |
| 15 | Restroom at/near Play Area |
| 16 | On-Site Parking Lot (~110 stalls) |
| 17 | Stormwater Basin |
| 18 | Nature Preserve Edge Fencing (Post and Cable) |

| GRAPHICAL LEGEND | |
|--------------------|--|
| [Red Box] | Structure (Metal Roof) |
| [Blue Box] | Structure (Fabric Roof) |
| [Green Circle] | Shade Tree |
| [Dark Green Box] | Grass (Natural) |
| [Dark Grey Box] | Asphalt |
| [Light Grey Box] | Concrete |
| [Brown Box] | Shrub Planter Area |
| [Orange Box] | Infield Fines (at Ballfields) |
| [Light Orange Box] | Wood Fiber Surfacing (at Playgrounds) |
| [Light Brown Box] | Decomposed Granite |
| [Dark Green Box] | Stormwater Basin |
| [Dashed Line] | Fence Tube Steel (at 2-5 year old Playground) |
| [Dashed Line] | Fence Post and Cable (at Open Space Edge) |
| [Dashed Line] | Fence Chain Link (at Dog Park and Ball Fields) |
| [Dashed Line] | Retaining Wall (9' height or less) |



\$20.72M

| KEY NOTE LEGEND | |
|-----------------|---|
| 1 | Children's Playground 2-5 year old (shaded, fenced) |
| 2 | Children's Playground 5-12 year old (shaded) |
| 3 | Jogging Walking Perimeter Loop Trail |
| 4 | Minor Shade Structure/Picnic Area |
| 5 | Large Shade Structure/Picnic Area |
| 6 | Baseball Field (300' depth, 90' bases, natural turf) |
| 7 | Baseball/Softball Field (200' depth, 60' bases, natural turf) |
| 8 | Football/Soccer/Lacrosse/etc. Field (natural turf) |
| 9 | Informal Turf Area with Shade Trees |
| 10 | Basketball Court |
| 11 | Covered Multi-Sport Field |
| 12 | Dog Park (Separate Small and Large Dog Areas) |
| 13 | Bike Park/Pump Track |
| 14 | Concession Stand with Restroom |
| 15 | Restroom at/near Play Area |
| 16 | On-Site Parking Lot (~180 stalls) |
| 17 | Stormwater Basin |
| 18 | Pickleball Courts (4) |

| GRAPHICAL LEGEND | |
|--------------------|--|
| [Red Box] | Structure (Metal Roof) |
| [Blue Box] | Structure (Fabric Roof) |
| [Green Circle] | Shade Tree |
| [Dark Green Box] | Grass (Natural) |
| [Dark Grey Box] | Asphalt |
| [Light Grey Box] | Concrete |
| [Brown Box] | Shrub Planter Area |
| [Orange Box] | Infield Fines (at Ballfields) |
| [Light Orange Box] | Wood Fiber Surfacing (at Playgrounds) |
| [Light Brown Box] | Decomposed Granite |
| [Dark Green Box] | Stormwater Basin |
| [Dashed Line] | Fence Tube Steel (at 2-5 year old Playground) |
| [Dashed Line] | Fence Post and Cable (at Open Space Edge) |
| [Dashed Line] | Fence Chain Link (at Dog Park and Ball Fields) |
| [Dashed Line] | Retaining Wall (9' height or less) |



City of
Lincoln

Thank You!

Questions?:

araceli.cazarez@lincolnca.gov

Latest Project Information and Survey:

lincolnca.gov
Bella Breeze Park Master Plan - City of Lincoln
(lincolnca.gov)